

FRONT VIEW

Pin #	Assignment
1	Top
2	Right
3	Bottom
4	Left

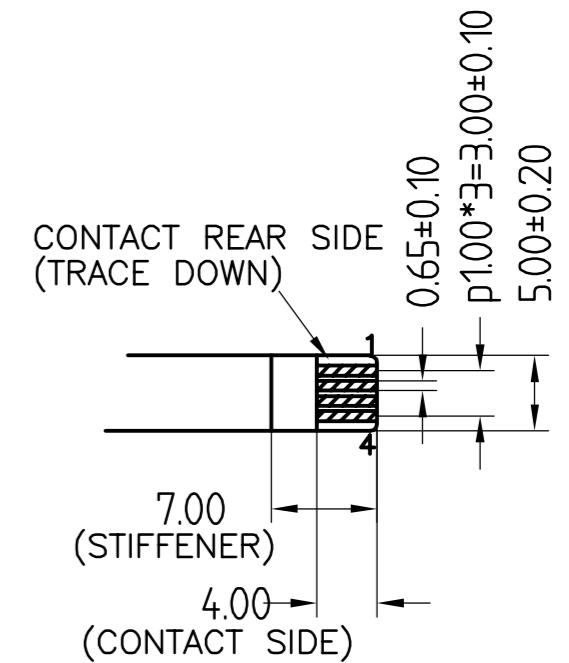

DETAIL A

NOTES:

1. ITO GLASS THICKNESS : 1.10mm
2. OVERALL THICKNESS : 1.40±0.10mm
3. CONNECTOR AND PINOUT AS INDICATED
4. FRONT SURFACE : ANTI-GLARE HARDCOAT
5. LAYER TO LAYER ASSEMBLY TOLERANCE: ±0.30mm
6. TAIL TYPE : FPC
7. OTHER SPEC : SEE APPROVAL SHEET

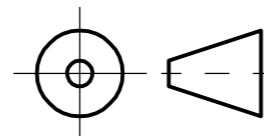

				2005	Datum	Name	Bezeichnung
				Erst.	25.01.	SSA	TOUCH 5,72" 4 Draht
				Gepr.	25.01.	Maurer	
				Norm			
				Maße ohne Toleranzangabe		Maßstab	Maßeinheit
				X	±0.5	%	mm
				XX	±0.5		
				XXX	±0.3		
						AMT-DWG-NR: 9532-0-01 / REV -	
						Manufactured by Apex Material Technology Corp.	
						Schurter-Bestell-Nr:	
						1070.0456	
Zust.	Änderung	Datum	Name			- REV	

SCHURTER
ELECTRONIC COMPONENTS